

SECTION VIEW "A" (EAST-WEST THRU STREET)
N.T.S.

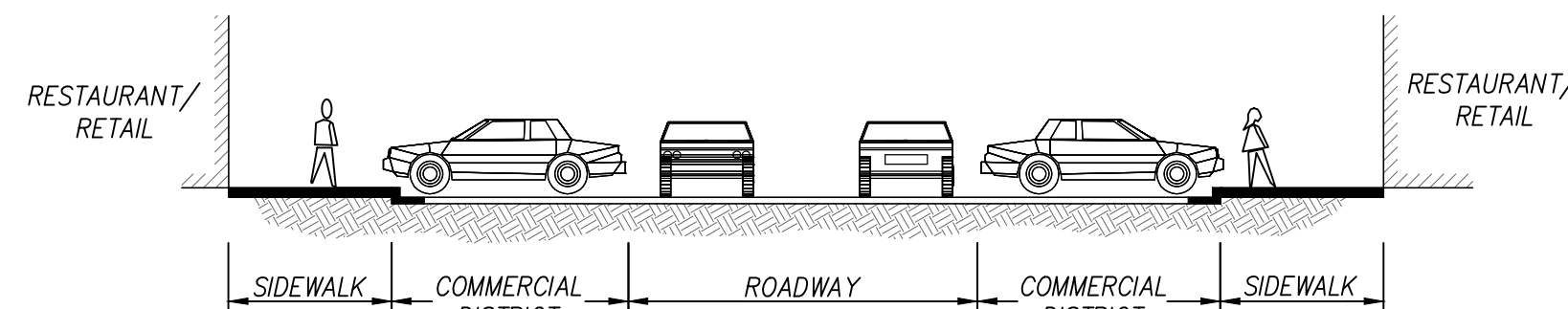

SECTION VIEW "B" (NORTH-SOUTH THRU STREET)
N.T.S.

BUILDING LANDSCAPE:
DETAILED, FLOWERING AND EVERGREEN
SHRUB MASSES, GROUNDCOVERS AND
LAWN SHALL BE INCORPORATED INTO
THE PROPOSED ARCHITECTURAL
IMPROVEMENTS TO ENHANCE THE
PLAZA HARDSCAPE (TYP.)

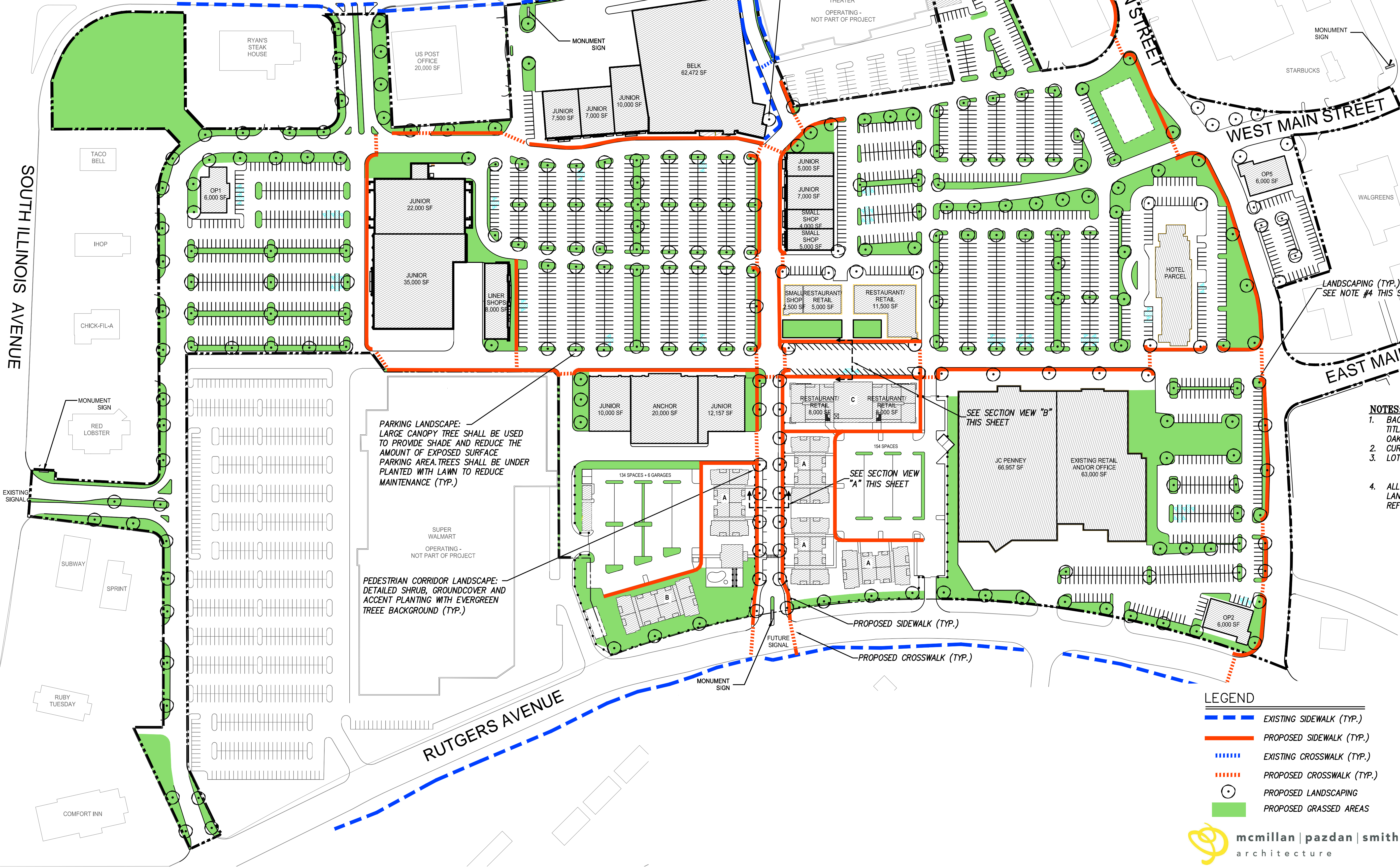
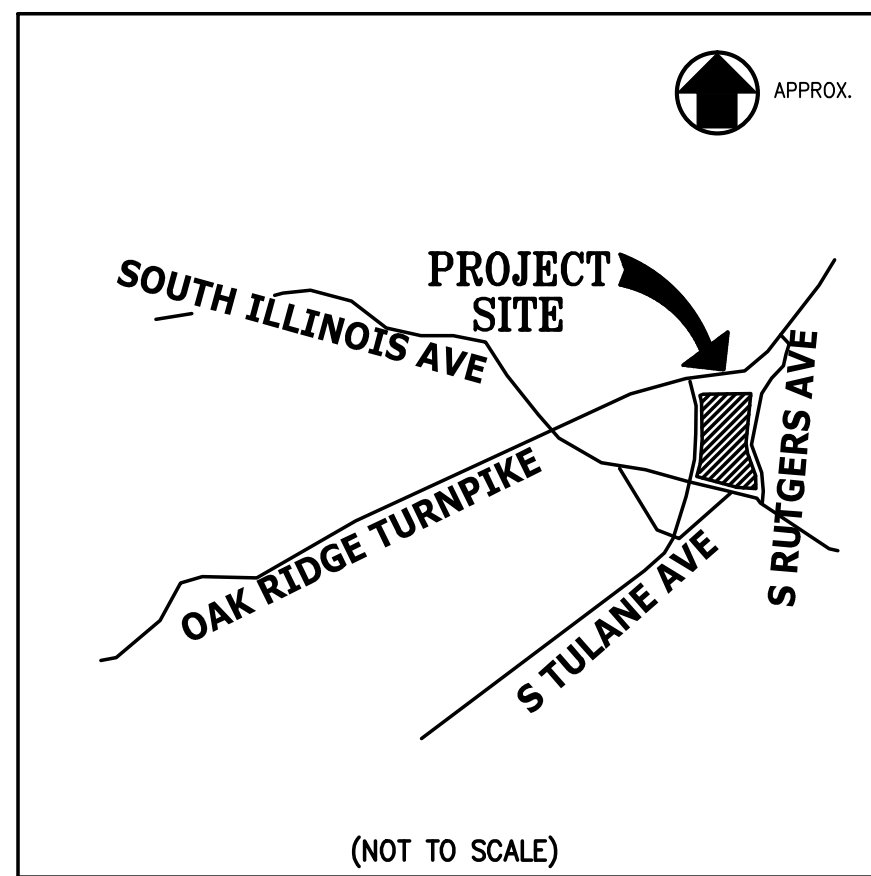
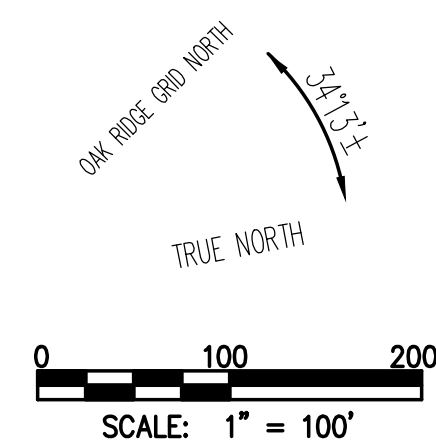

- NOTES:**
1. BACKGROUND INFORMATION TAKEN FROM ALTA/ACSM LAND TITLE SURVEY PERFORMED MAY 2013 OF OAK RIDGE MALL, OAK RIDGE, TN. FOR CROSLAND SOUTHEAST.
 2. CURRENT ZONING IS B-2. TO BE REZONED TO UB-2.
 3. LOTS:
PARCEL 003.00 TAX ID 099L A =65.0 AC.
PARCEL 036.00 TAX ID 009L A =00.73 AC.
 4. ALL LANDSCAPING SHALL ADHERE TO CITY OF OAK RIDGE LANDSCAPING ORDINANCE. ALL LANDSCAPING SHOWN IS FOR REFERENCE ONLY.

- LEGEND**
- EXISTING SIDEWALK (TYP.)
 - PROPOSED SIDEWALK (TYP.)
 - EXISTING CROSSWALK (TYP.)
 - PROPOSED CROSSWALK (TYP.)
 - PROPOSED LANDSCAPING
 - PROPOSED GRASSED AREAS

mcmillan | pazdan | smith
architecture

REVISIONS		DATE
CANNON & CANNON INC CONSULTING ENGINEERS - FIELD SURVEYORS TEL 865.670.8555 8550 Kingston Pike WWW.CANNON-CANNON.COM Knoxville, TN 37919		
CROSLAND SOUTHEAST		
MAIN STREET OAK RIDGE		
PEDESTRIAN CONNECTIVITY & CONCEPTUAL LANDSCAPE PLAN		
CCI PROJECT NO. 01160-0000		
DRAWING DATE MARCH 16, 2015		
P.I.C.	HED	C.R.
DRAWN	LED	
MP 2.01		